

T4A4H-001

Mechanical Friction Multi-Disc Torque Limiter with Integral Pulley and Shrink Disc



Designed for brief overloads.
Does not automatically disconnect.

Engagement/Disengagement

Spring/None

Facing Type

High Coefficient

Minimum Torque Setting

390 Pound Inches

Maximum Torque Setting (Spring Compression ≈ 27%)

3,940 Pound Inches

Maximum RPM

1,750

Bore with No Keyway

1.250

Finish

Aluminum

Open or Enclosed Construction

Open

Shipping Weight

10 Pounds

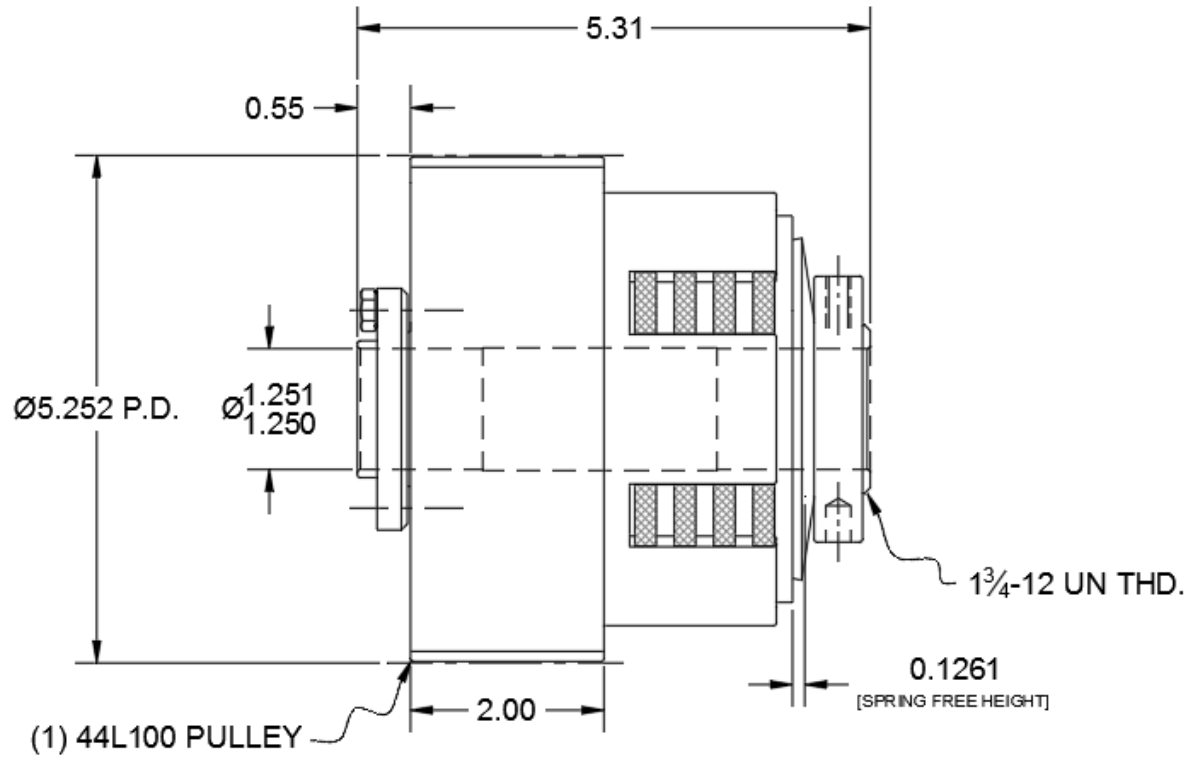

TORQUE vs. SPRING PRESSURE

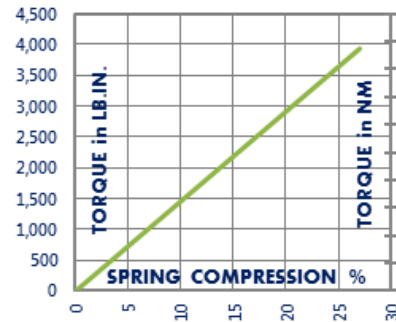

NEW vs. BURNISHED TORQUE

The torque output setting of a friction torque limiter is set at the factory or in the field when new. (All torque settings are +/- 10%.) Repeated overload will burnish the friction surfaces and may increase the slip torque setting. The torque setting should be tested after prolonged or frequent overload and re-set if needed.

PRODUCT SELECTION

Torque capacity is only one factor to consider when making a product selection. Ensure that you will have the right product for the job by contacting our engineering department for application review and selection assistance.



101 Cummings Drive
Walton, KY 41094 USA

859-291-0849

machiii.com

engineering@machiii.com

T4A4H-001

Parts Diagram

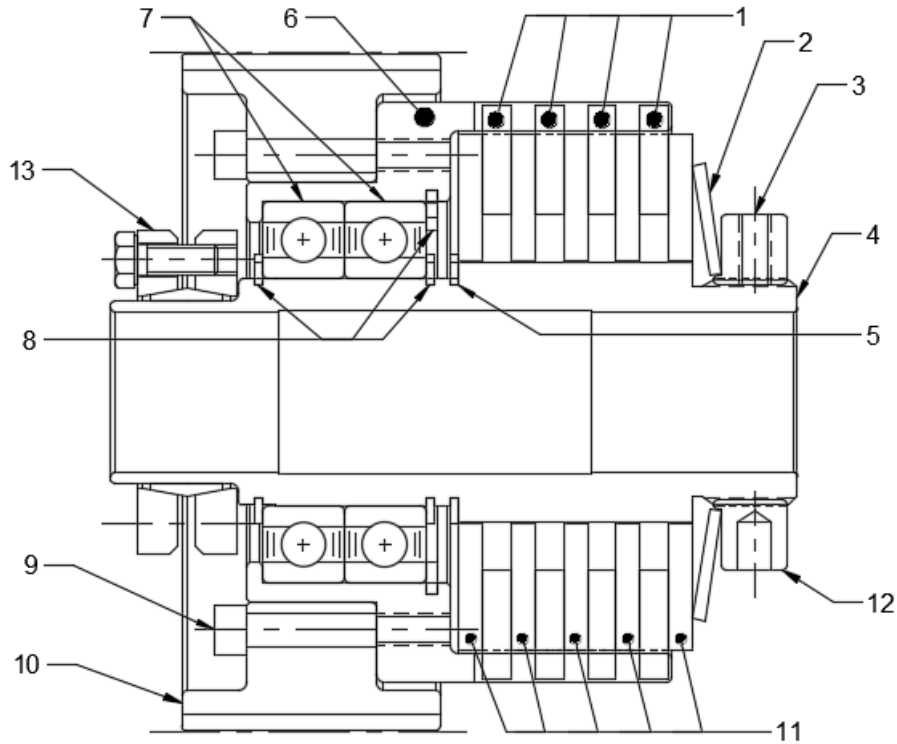

REF#	DESCRIPTION & PARTS INCLUDED	QUANTITY	KIT NUMBER
	REPAIR KIT		T4A4H-001-RPRK
1	Friction Disc	4	
2	Disc Spring	1	
3	Nylon Point Set Screw	1	
	DRIVE HUB KIT		T4A4H-001-HUBK
4	Drive Hub	1	
5	Retainer Ring	1	
	SLEEVE KIT		T4A4H-001-SLVK
6	Sleeve	1	
7	Bearing	2	
8	Retainer Ring	3	
	PULLEY KIT		T4A4H-001-PULK
9	Screw	6	
10	Pulley	1	
	DRIVE DISC KIT		T4A4H-001-DRDK
11	Drive Disc	5	
	FACING KIT		T4A4H-001-FCGK
1	Friction Disc	4	
3	Nylon Point Set Screw	1	
	NUT KIT		T4A2H-STL-NUTK
3	Nylon Point Set Screw	1	
12	Nut	1	
	CLAMP COLLAR KIT		T4A4H-001-CLCK
13	Clamp Collar	1	

PARTS KITS

The *Repair Kit* contains common wear items for this product. Users are encouraged to stock one or more repair kits considering the number of units installed and the potential downtime if machinery on which the unit is installed is critical equipment. To obtain current pricing and lead time for parts kits, contact customer service.

orders@machiii.com

ADDITIONAL PRODUCT INFORMATION

For illustrated guides showing how Mach III products work, selection guidelines, product manuals, and installation and use recommendations:

<https://machiii.com/resources/how-our-products-work>

For information about how to order, return policy and warranty information:

<https://machiii.com/resources/how-to-order>



859-291-0849

machiii.com

engineering@machiii.com