

T3G1F-001

Mechanical Friction Torque Limiter with Square Input and Output



Designed for brief overloads.
Does not automatically disconnect.

Engagement/Disengagement

Spring/None

Facing Type

Low Coefficient

Minimum Torque Setting

40 Pound Inches

Maximum Torque Setting (Spring Compression ≈ 75%)

400 Pound Inches

Maximum RPM

1,750

Bore without Keyway

24 mm

Finish

Stainless Steel

Open or Enclosed Construction

Enclosed

Shipping Weight

4 Pounds

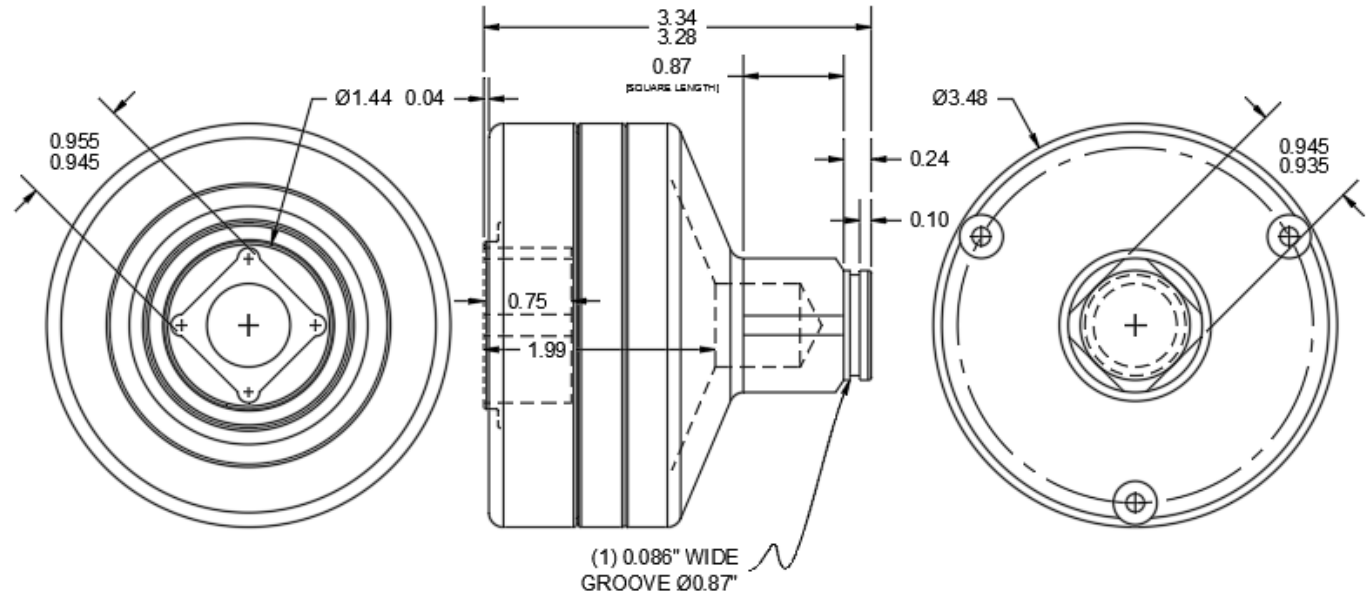

TORQUE vs. SPRING PRESSURE

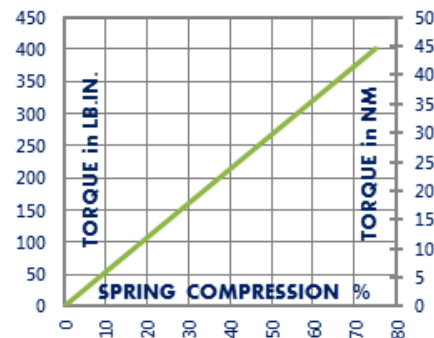

NEW vs. BURNISHED TORQUE

The torque output setting of a friction torque limiter is set at the factory or in the field when new. (All torque settings are +/- 10%.) Repeated overload will burnish the friction surfaces and may increase the slip torque setting. The torque setting should be tested after prolonged or frequent overload and re-set if needed.

PRODUCT SELECTION

Torque capacity is only one factor to consider when making a product selection. Ensure that you will have the right product for the job by contacting our engineering department for application review and selection assistance.



101 Cummings Drive
Walton, KY 41094 USA
859-291-0849
machiii.com

engineering@machiii.com

T3G1F-001

Parts Diagram

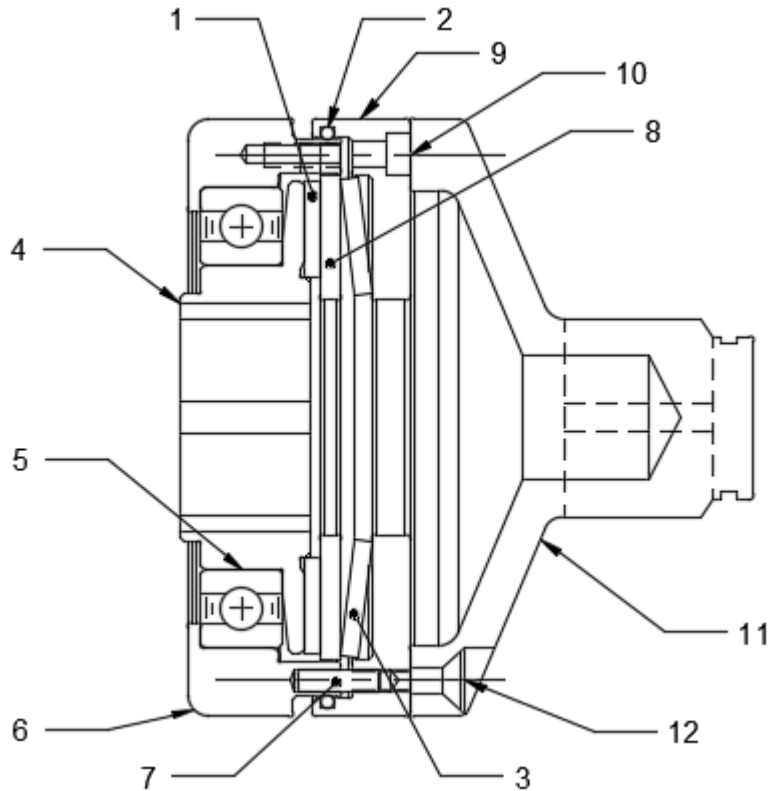

REF#	DESCRIPTION & PARTS INCLUDED	QUANTITY	KIT NUMBER
	REPAIR KIT		T3G1F-001-RPRK
1	Friction Disc	1	
2	O-Ring	1	
3	Disc Spring	1	
4	DRIVE HUB	1	T3G1F-001-P001
	SLEEVE KIT		T3G1F-001-SLVK
5	Bearing	1	
6	Sleeve	1	
7	Pin	4	
8	DRIVE DISC KIT	1	T3G1F-001-P005
	FACING KIT		T3G1F-001-FCGK
1	Friction Disc	1	
	COVER KIT		T3G1F-001-COVK
9	Cover	1	
10	Screw	3	
	COUPLING KIT		T3G1F-001-CPLK
11	Coupling	1	
12	Screw	3	

PARTS KITS

The *Repair Kit* contains common wear items for this product. Users are encouraged to stock one or more repair kits considering the number of units installed and the potential downtime if machinery on which the unit is installed is critical equipment. To obtain current pricing and lead time for parts kits, contact customer service.

orders@machiii.com

ADDITIONAL PRODUCT INFORMATION

For illustrated guides showing how Mach III products work, selection guidelines, product manuals, and installation and use recommendations:

<https://machiii.com/resources/how-our-products-work>

For information about how to order, return policy and warranty information:

<https://machiii.com/resources/how-to-order>



859-291-0849

machiii.com

engineering@machiii.com